

Construction Drawings for
MIDIbox Genesis MDF Case
Design by Technobreath – Rev. 4 - 2017

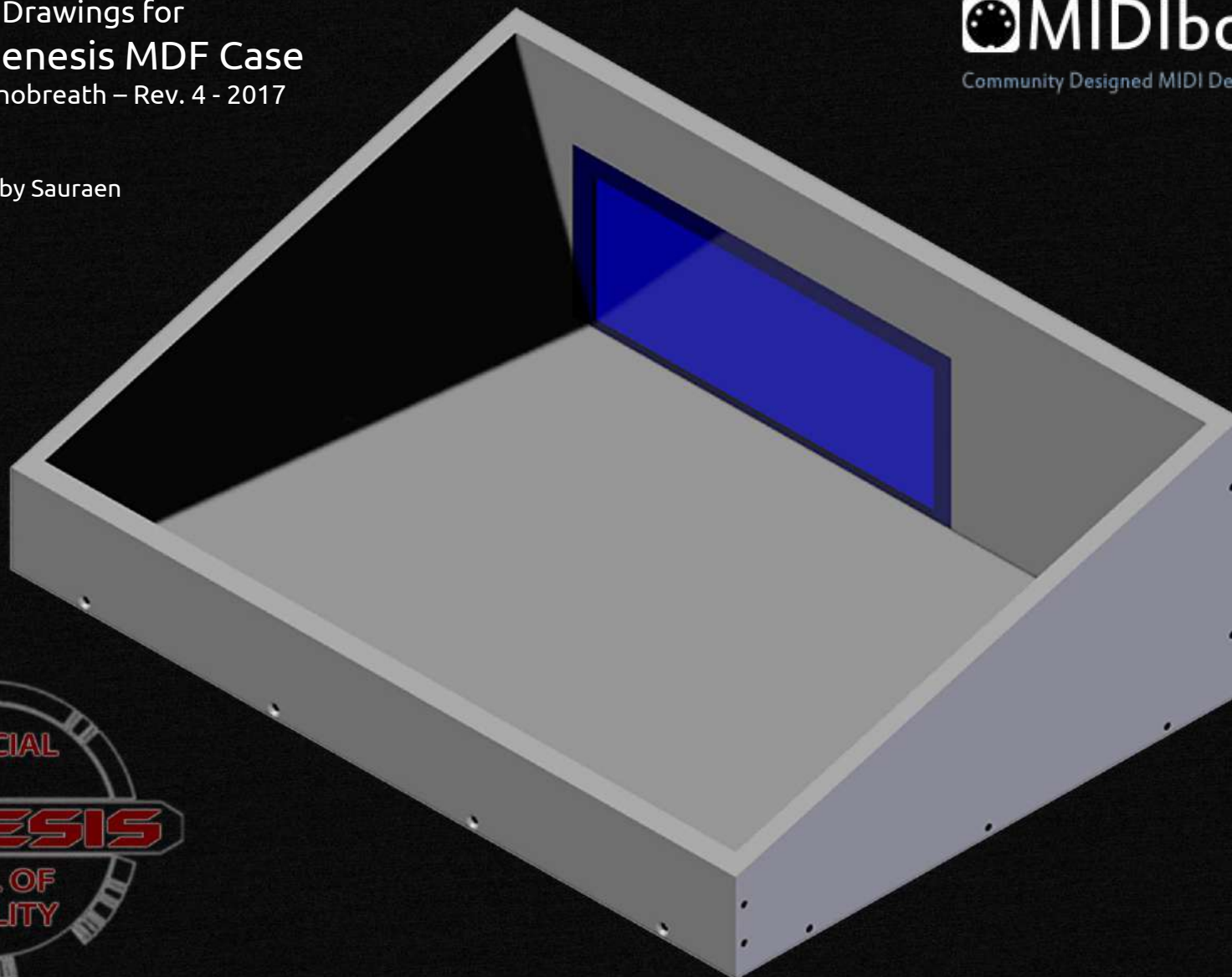

Fits CS designed by Sauraen



Tips for building:

These plans are based around using 9mm MDF sheets. If other materials and dimensions are used, the plans must obviously be adapted to this.

It is also assumed that you use 3.5x20 mm countersink screws.

A caution about screws and MDF: This material isn't as flexible as real wood, and will crack if pilot holes aren't drilled.

The size of pilot holes will vary (depends on the type of screws used). But 2.5mm is a good place to start.

When screwing in MDF, you want pilot holes large enough for it to not crack, and small enough for it to complain a little bit when screwing them.

It is highly recommended to use woodglue on all joined surfaces.

The blue panel on the back represents a sheet of aluminium, polycarbonate or similar. This is for drilling holes for the connectors etc. you would like to have on the back.

There are not any details on how to actually construct this panel – you would probably like to make it the way you want it – but the drawings will give you an idea on how to do it.

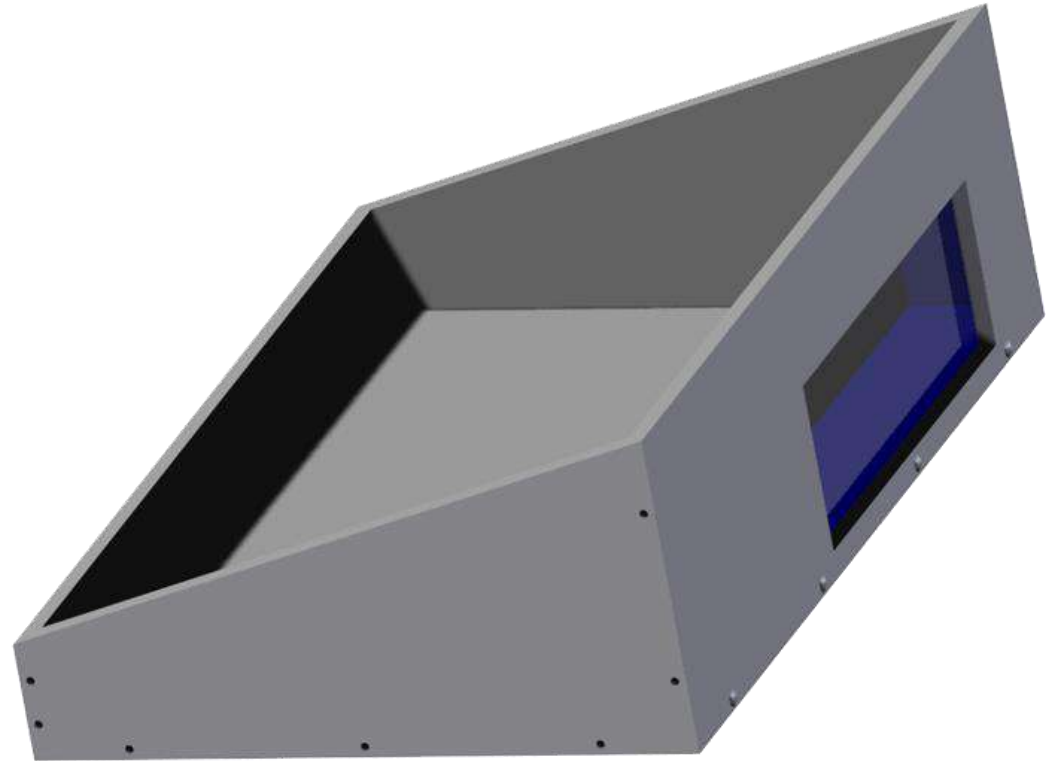

Assembly

Exploded 3D view

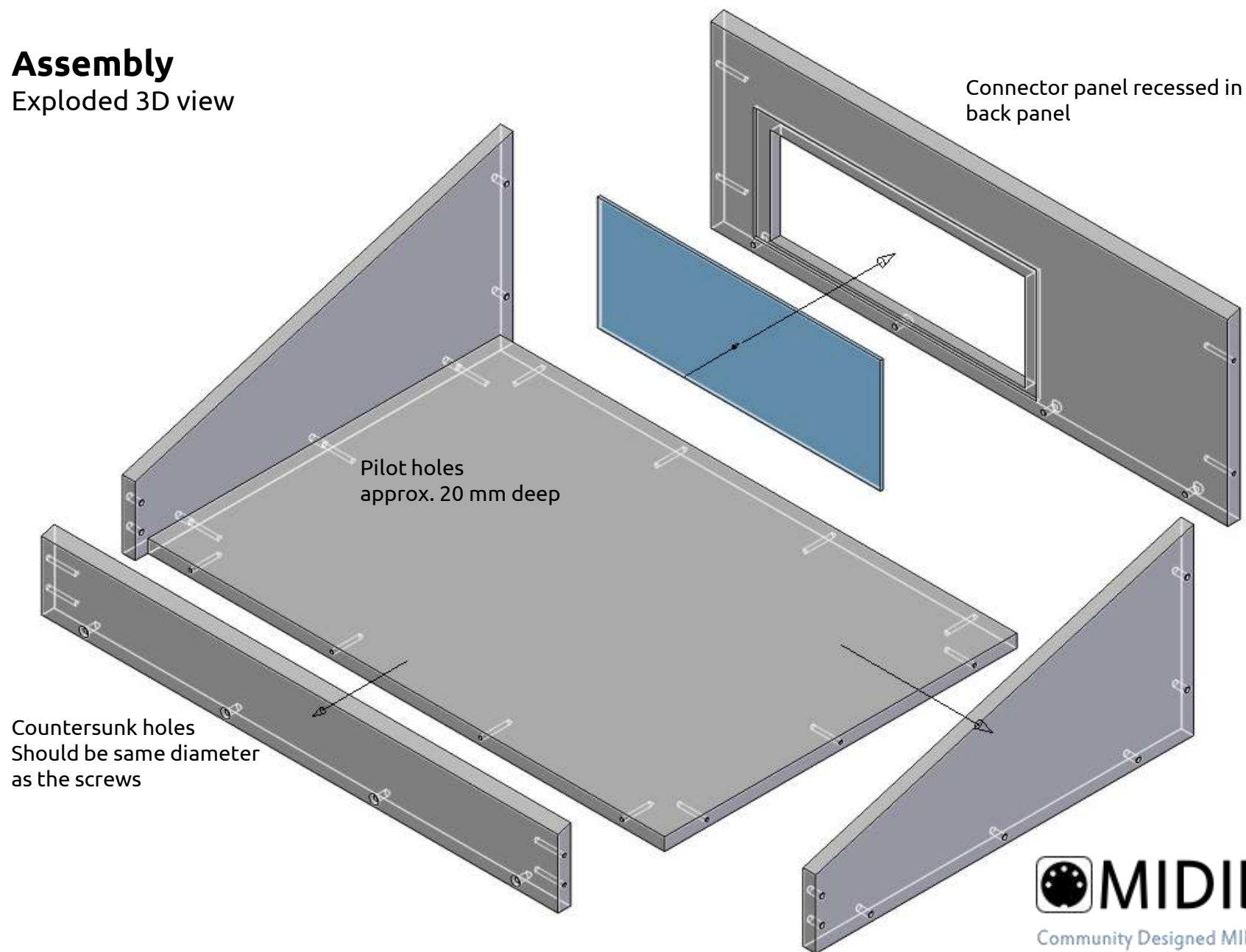

Side panel

3D view

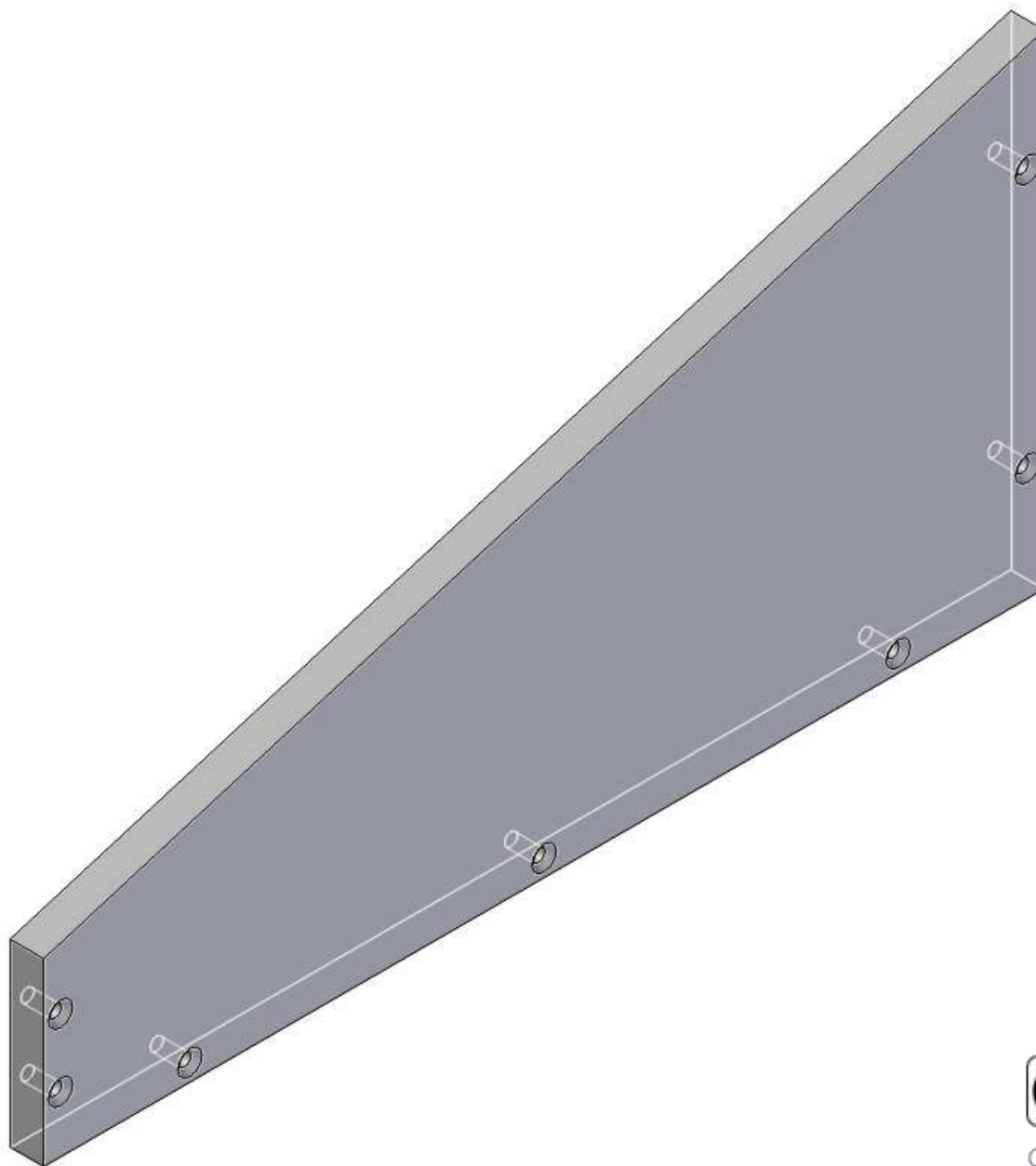

Side panel

Side view

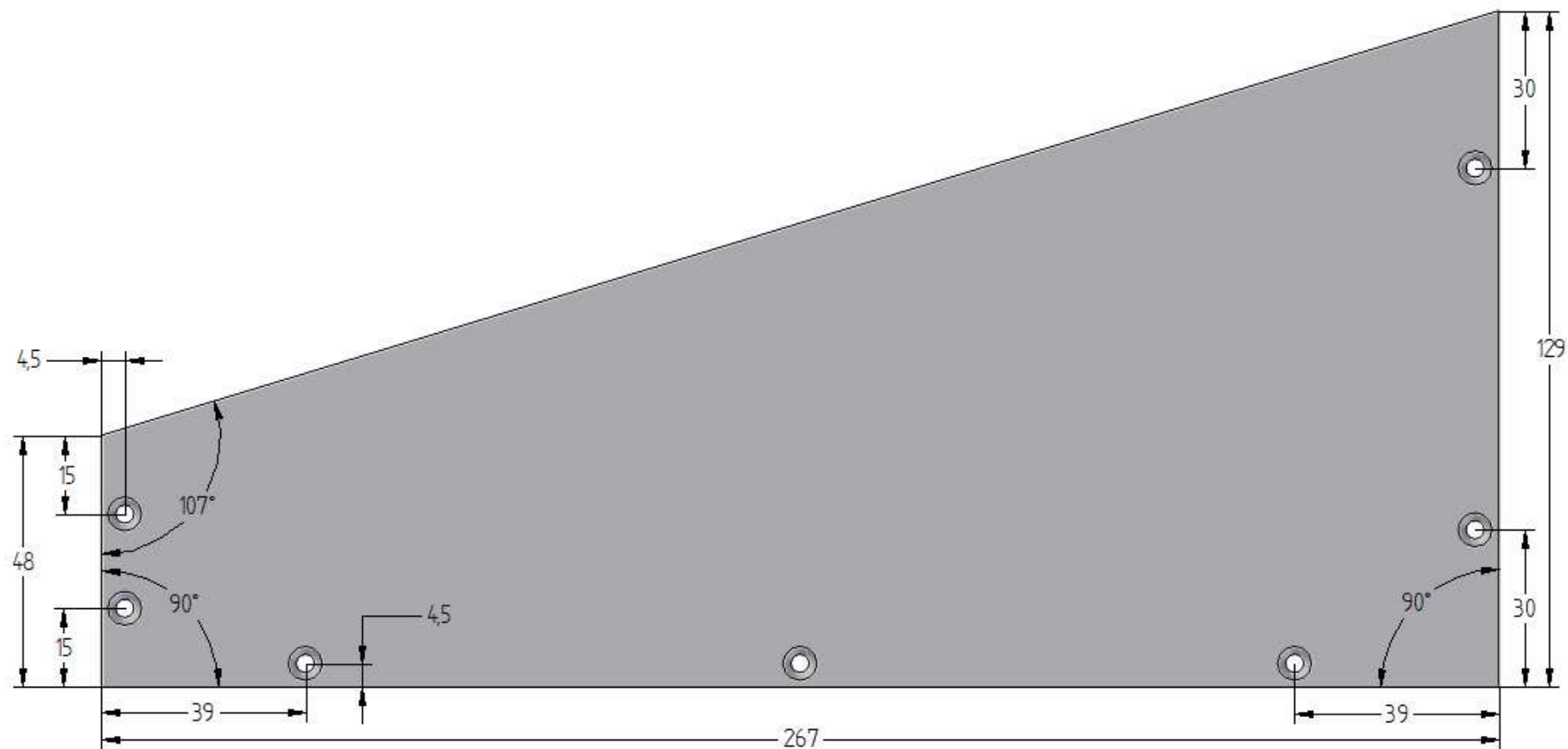

Nether panel

3D view

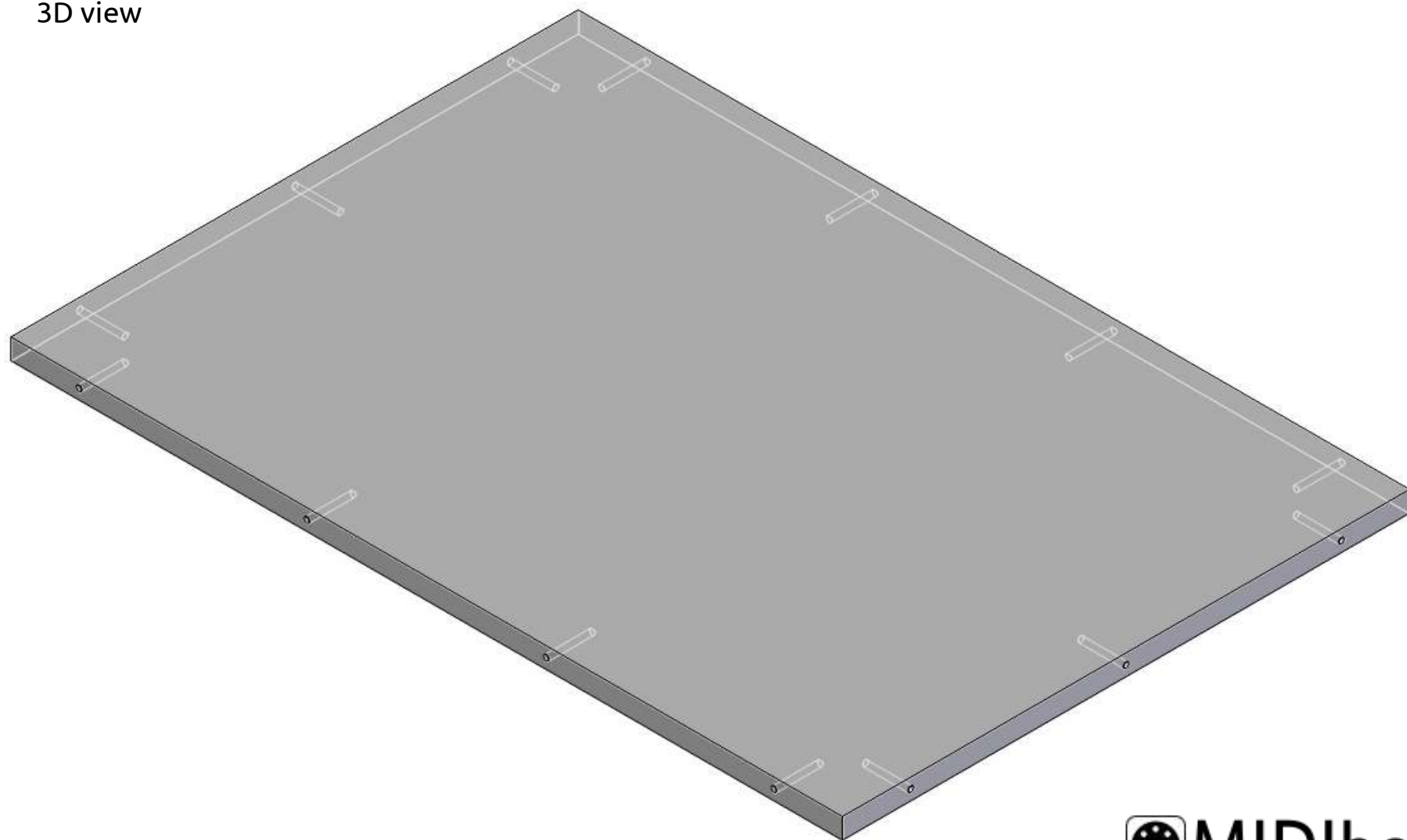

Nether panel

Front view

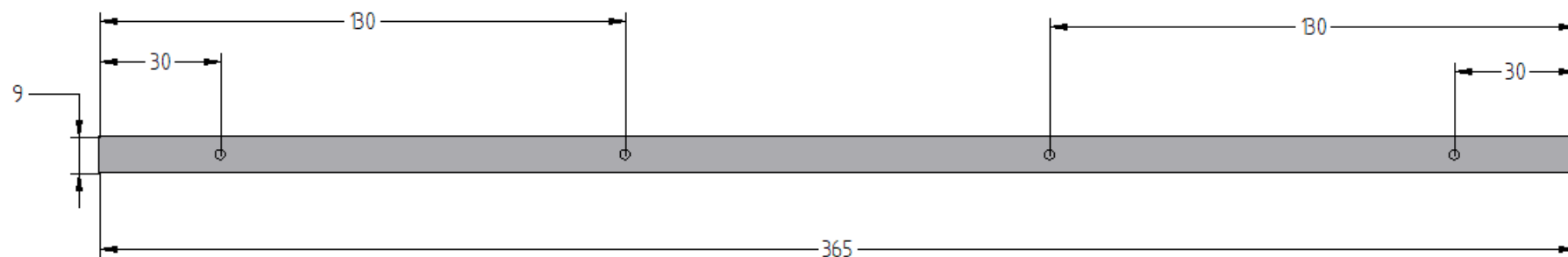

Nether panel

Side view

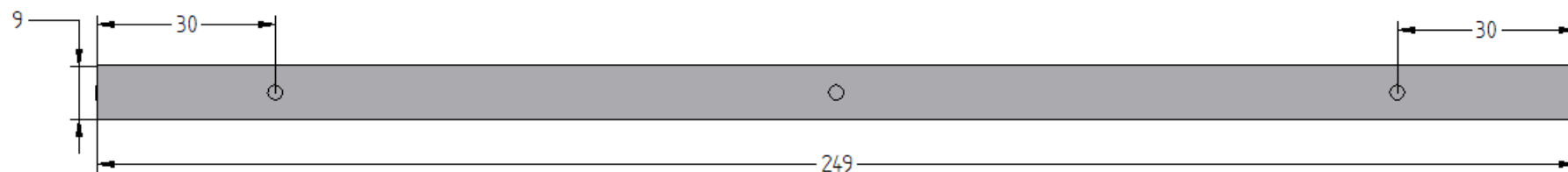

Nether panel

Top view



MIDIbox

Community Designed MIDI Devices

Back panel

3D view

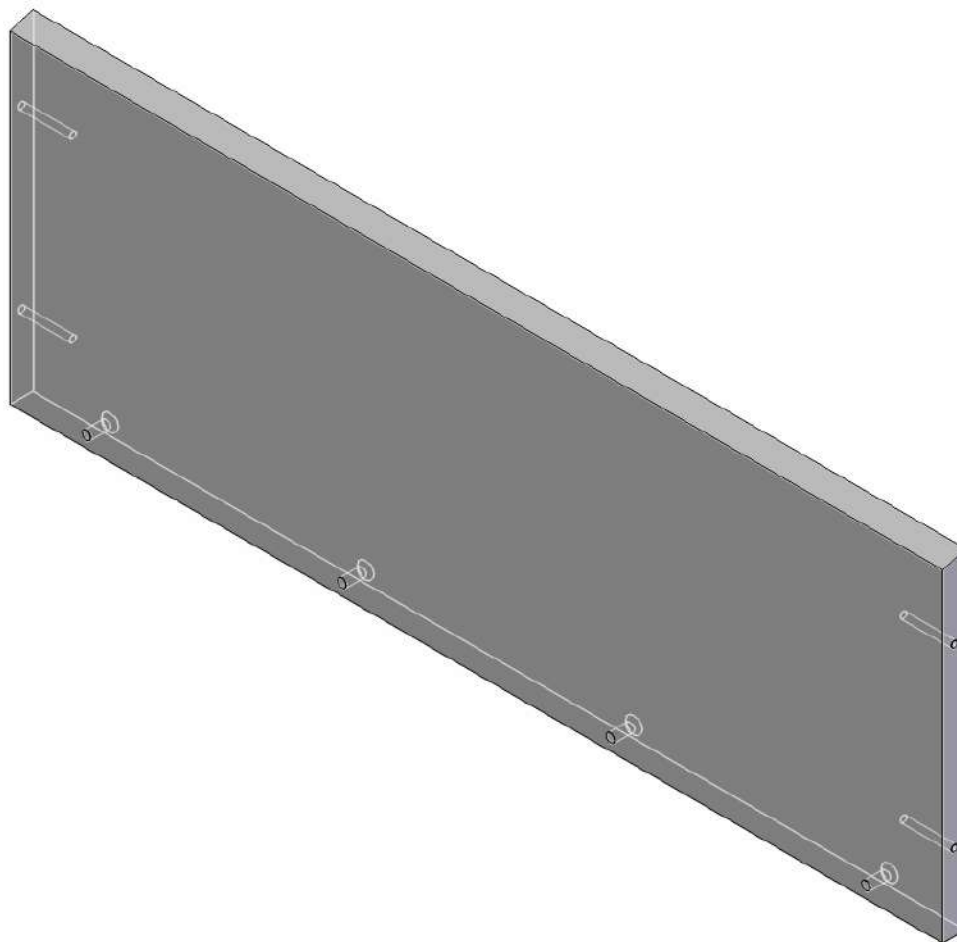

Front view

Back panel

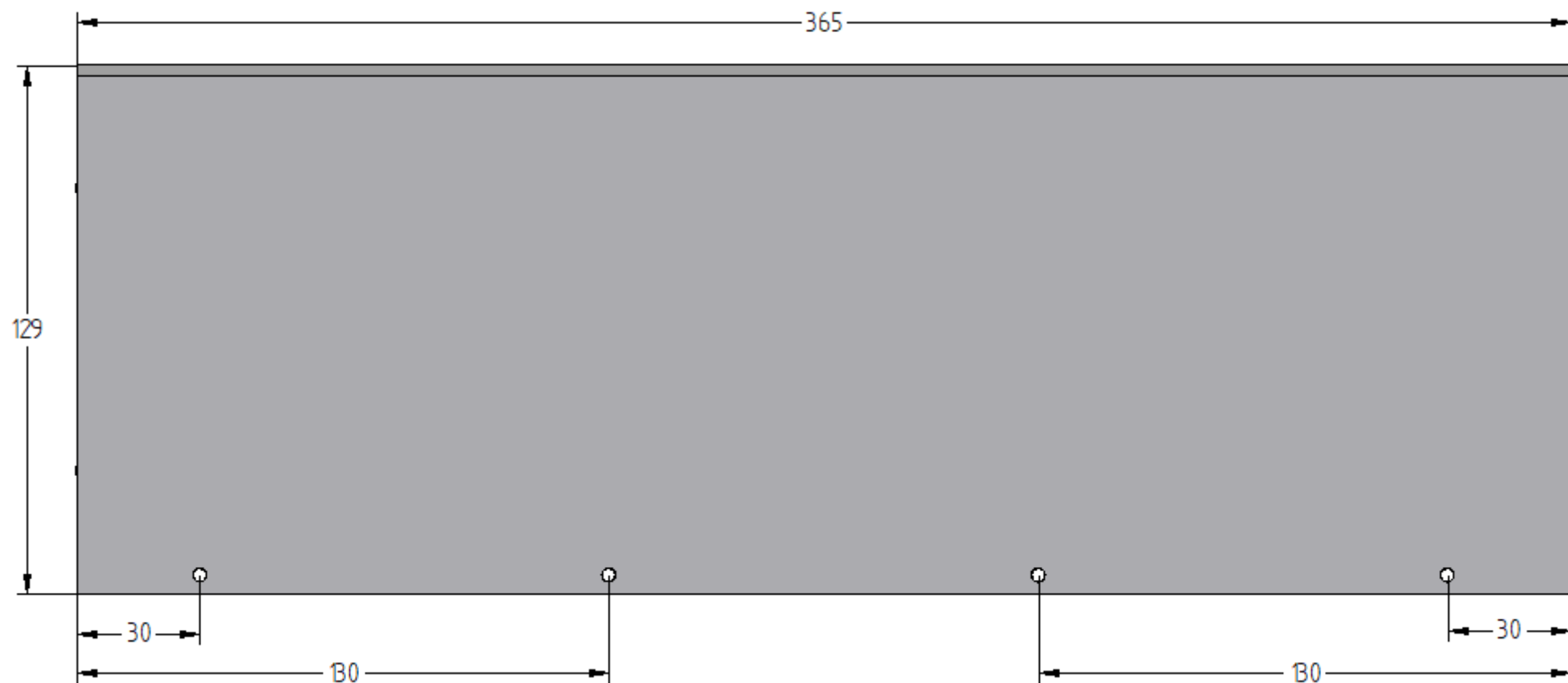

Back panel

Side view (rotated 90 deg.)

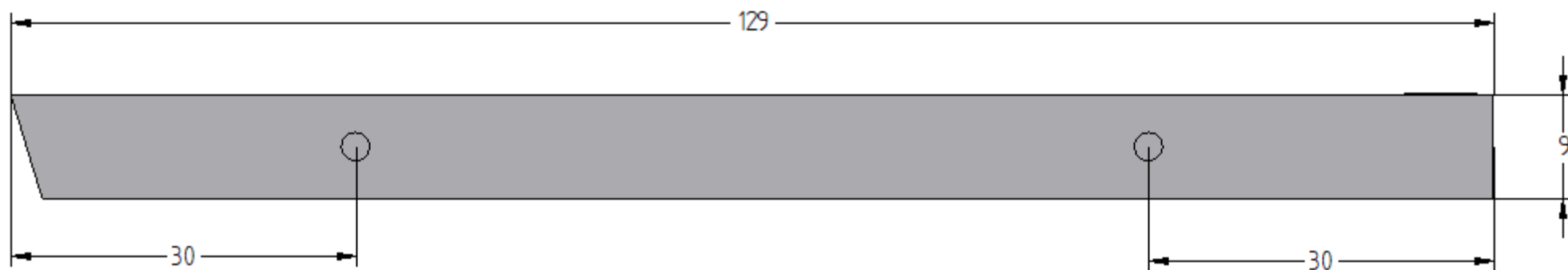

Front panel

3D view

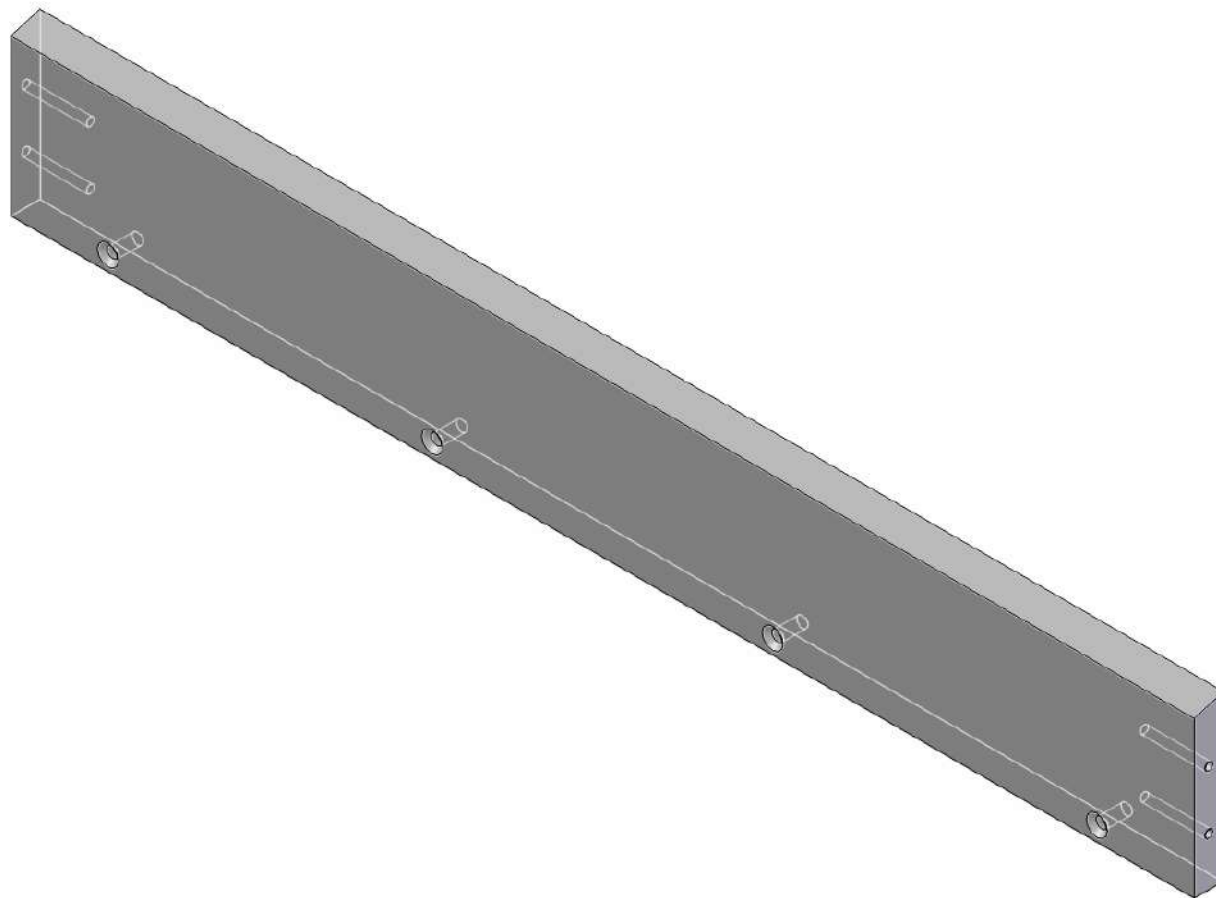

Front panel

Front view

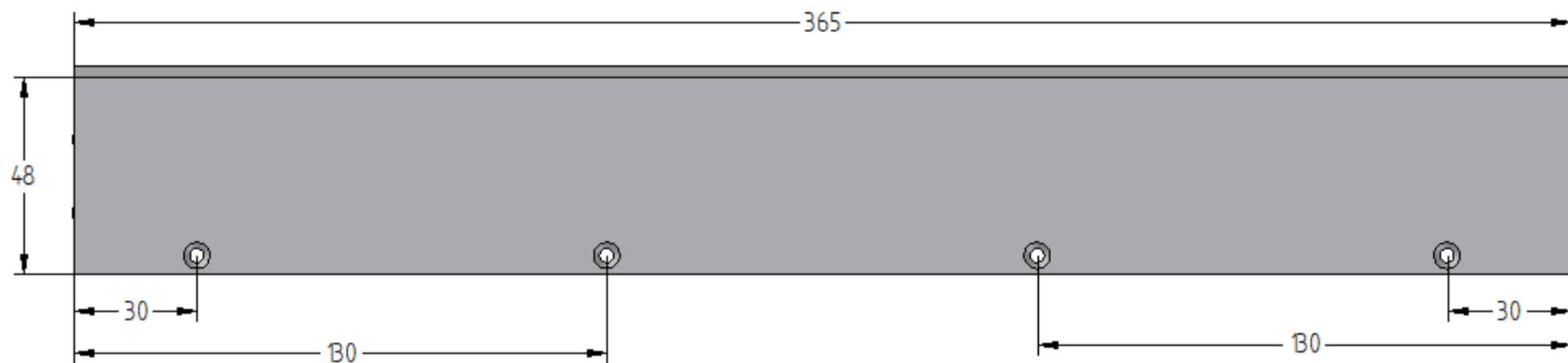

Front panel

Side view (rotated 90 deg.)





DISCLAIMER:

In no way in this or another universe is Technobreath responsible for the outcome of using these drawings.

Every individual is responsible for making sure that the dimensions given here will fit the control surface. Not only is the builder responsible to check this before building the case – it is the sensible thing to do.

Questions regarding design and build can be directed to related forum posts and PM to Technobreath – fast replies on PMs are not guaranteed in any way.

From these plans you can build the case with minimal amounts of tool, but however you choose to build this, it is important to be very thorough when you measure, draw and cut.

Finish the case with paint or other sealing agent, as MDF will swell if it becomes wet.

These plans are not to be reposted, modified without the written permission from the author. I will become grumpy if others claim my work as their own.

With all that said – Have fun
- Technobreath